

SITE PLAN OF HOLDING NO.- 1159, MOUZA - KUMROKHALI, DAG. NO. - 1487, 1489, 1486, 1488, L.R. DAG NO.- 1565, 1566, 1567, 1568 , KHATIAN NO.- 260, 264, 213,206, L.R. NO.- 2254, J.L NO. -48 P.S. - SONARPUR, WARD NO. - 27, P.S. - SONARPUR. DIST.- 24 PGS(S). UNDER RAJPUR SONARPUR MUNICIPALITY.

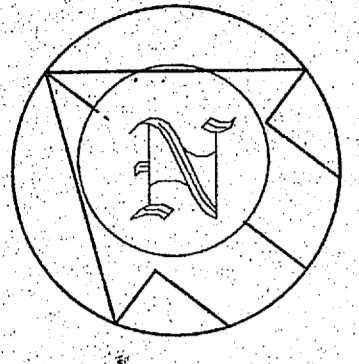

AREA OF LAND (as per deed) :- 61 SATAK = 2472.89 SQM
 AREA OF LAND (as per physical) :- 2524.215 SQM
 EXCESS LAND THROWN TO MUNICIPALITY :- 51.325 SQM
 NET AREA OF LAND : 2472.89 SQM
 BOUNDARY DEMARCATED BY RED BORDER.
 SCALE:- 1:100

DECLARATION OF E.B.A

THE SITE IS MEASURED BY ME. AND IT TALLIES WITH THE DEED PLAN. AND ACTUAL MEASUREMENT. MENTIONED IN THE PROPOSED PLAN.

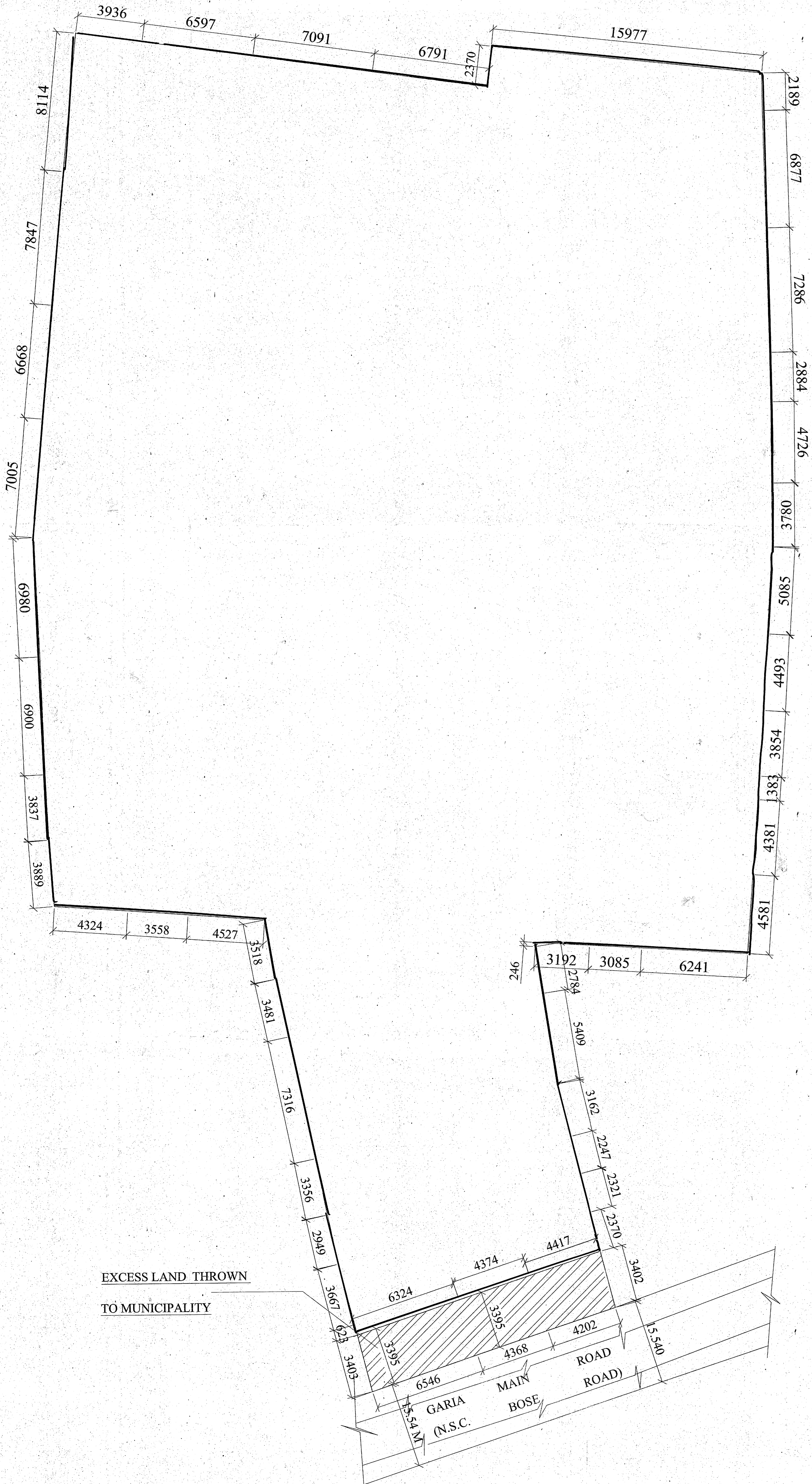

SUBIR C. SANYAL
 E.S.E. NO. 027
 UNDER RAJPUR SONARPUR MUNICIPALITY
 SIGNATURE OF E.B.A

DECLARATION OF OWNER

THE RED MARKED PORTION OF LAND IS IN MY POSSESSION AND IT IS FREE FROM ALL ENCUMBRANCES.

RAJWADA GROUP
 Rajwada Group Partner
 RAJWADA GROUP
 Rajwada Group Partner
 RAJWADA GROUP
 Rajwada Group Partner
 RAJWADA GROUP
 Rajwada Group Partner
 As Legally Constituted
 Attorneys of
 GODAVARI LAND & REAL
 ESTATE PVT. LTD.
 SIGNATURE OF OWNER

APPROVED
 Plan No. 883/27/Key/27/80
 29/07/2003
 Municipal Engineer
 RAJPUR SONARPUR MUNICIPALITY

OFFICE USE ONLY